



6, Atherton Court St. Marks Avenue, Salisbury, Wiltshire, SP1 3UF

A superb spacious upper ground floor three bedroom apartment with allocated parking space and single garage.

- UPPER GROUND FLOOR APARTMENT
- UNFURNISHED
- DRAWING ROOM WITH BALCONY
- THREE BEDROOMS (ONE WITH EN-SUITE)
- LOCATED WITHIN WALKING DISTANCE OF SALISBURY CITY CENTRE
- ALLOCATED PARKING SPACE AND SINGLE GARAGE
- COUNCIL TAX BAND F
- EPC BAND C
- SORRY NO PETS

£1,300 Per Calendar Month

Floor Plan

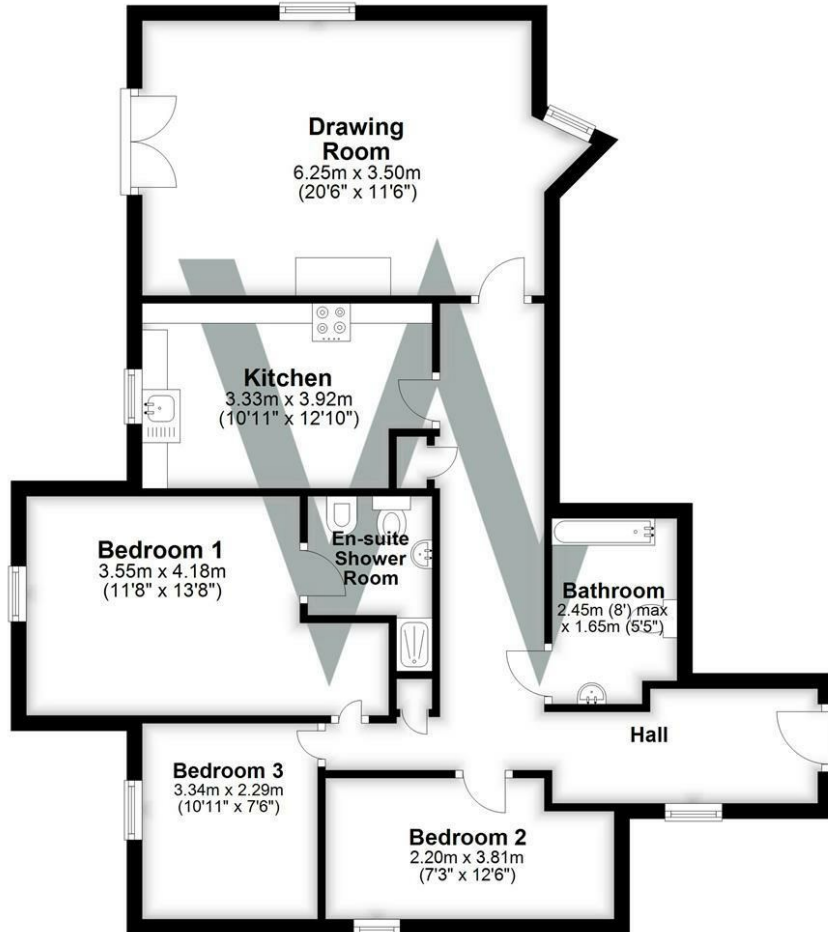

WHITES

Castle Chambers, 47 Castle Street, Salisbury,
 Wiltshire, SP1 3SP
 Tel: 01722 336422/Option 2
 www.hwwhite.co.uk
 email: lettings-management@hwwhites.co.uk

Energy Efficiency Rating		Current	Potential
Very energy efficient - lower running costs			
(92 plus) A			
(81-91) B			
(69-80) C			
(55-68) D			
(39-54) E			
(21-38) F			
(1-20) G			
Not energy efficient - higher running costs			
England & Wales		80	80
	EU Directive 2002/91/EC		

Environmental Impact (CO ₂) Rating		Current	Potential
Very environmentally friendly - lower CO ₂ emissions			
(92 plus) A			
(81-91) B			
(69-80) C			
(55-68) D			
(39-54) E			
(21-38) F			
(1-20) G			
Not environmentally friendly - higher CO ₂ emissions			
England & Wales			
	EU Directive 2002/91/EC		